

# CLSI-016J7

## ADSL2+/POTS Krone MDF splitter



### Špecifikácia

ADSL2+/POTS Krone MDF splitter CLSI-016J7 oddeľuje ADSL signál a analógovú alebo digitálnu telefónnu linku. Hardvérové riešenie so zastrkovacou Krone časťou je vhodné pre použitie v Krone LSA+ konektoroch.

### Funkcie a vlastnosti

- Malé rozmery
- Jednoduchá inštalácia
- Použitie v Krone LSA+ konektoroch

### Obsah balenia

- 1x ADSL2+/POTS Krone splitter CLSI-016J7

## Parametre

- Všeobecné

Kompatibilné s Krone LSA+ séria 2 MDF  
 ISDN-Combo splitter  
 POTS 600 Ohm a ISDN 135 Ohm (2B1Q)  
 Dolný filter LP  
 Horný filter HP 2x27nF  
 Prepäťová ochrana  
 Splňa ETSI TS 101 952-1-4  
 Kompatibilita s ADSL2+  
 Pasívne komponenty a V0 podľa UL94  
 Slučkový prúd do 100mA  
 Pracovná teplota -40°C do 70°C

- Elektrické charakteristiky

Splitter parameters	Range	Values
DC resistnace to earth		$\geq 20M\Omega$
DC insulation resistance between A - wire and B - wire		$\geq 5M\Omega$
DC series resistance		$\leq 12.5\Omega$
Pass band insertion loss for ISDN (with ADSL2+ load)	1-60KHz	<1.2dB
	60-80KHz	<2.0dB
Pass band insertion loss for ISDN (without ADSL2+ load)	1-60KHz	<1.5dB
	60-80KHz	<2.5dB
Pass band return loss for ISDN (with ADSL2+ load)	1-60KHz	>16.0dB
	60-80KHz	>14.0dB
Pass band return loss for ISDN (without ADSL2+ load)	1-60KHz	>12.0dB
	60-80KHz	>10.0dB
Requirements relating to metering pulses at 12KHz or 16KHz	12-16KHz	<3.0-5.0dB
Unbalance about earth	0.05-4KHz	>40.0dB
	4-30KHz	>40.0dB
	30-1104KHz	>50.0dB
	1.1-2.2MHz	>30.0dB
Isolation requirements (ISDN)	150-1104KHz	>65.0dB
	1-2.2MHz	>55.0dB
Audible noise level requirements		$\geq 75dBm/Hz$
ADSL2+ band noise level requirements (a LE splitter)	138-2208KHz	$\geq 125dBm/Hz$
ADSL2+ band noise level requirements (a TE splitter)	138-2208KHz	$\geq 140dBm/Hz$
POTS band inter modulation distortion requirements		>57dB@2nd
		>60dB@2nd
ISDN band delay distortion	1-80KHz	<20uS
ADSL2+ insertion loss	120-170KHz	<3dB
	170-2208KHz	<1dB
Requirements related to POTS transient effects		$\leq 2Vp-p$

- Štruktúra

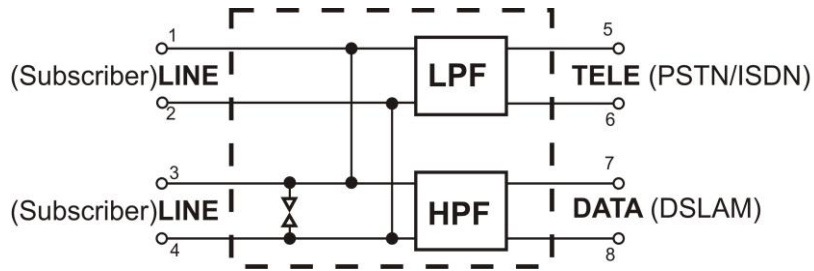

- Rozmery

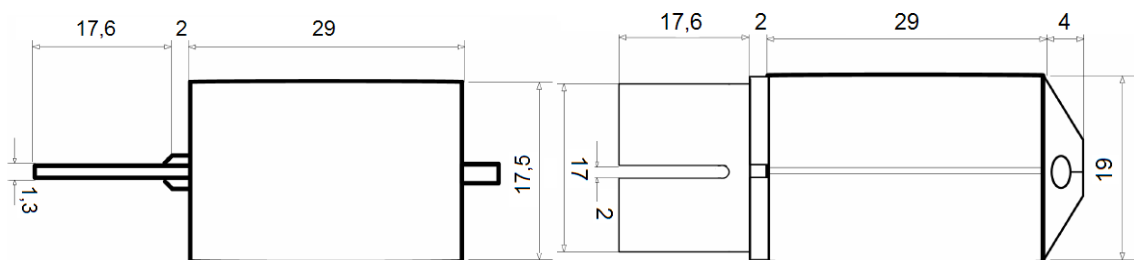

- Impedančné hodnoty

